

EKP1L

LCD KEYPAD

Owner's Manual



use with
AV9000 series Control panels

IT IS IMPORTANT FOR YOUR SAFETY TO TEST YOUR
SYSTEM AND IT'S COMPONENTS REGULARLY.

ARROWHEAD
A PRODUCT OF SENTROL, INC

OPERATING INSTRUCTIONS

Paragraphs that are indicated by a ☐ refer to options that may or may not apply to your system. Those ☐ which your installer has marked with an "x" should be read as they contain information which pertains to your system.

The material in this publication is for information purposes only and is subject to change without notice. SENTROL, INC., assumes no responsibility for any error which may appear in this publication.

SYSTEM CONFIGURATION

This page should be marked by your installer at the time of installation to define the Panel that was installed, and the options that were programmed.

OPTIONS PROGRAMMED:

☐ **SMOKE DETECTOR RESET FROM KEYPAD**

☐ **DURESS FROM KEYPAD**

☐ **SILENT ALARM FROM KEYPAD**

☐ **AUDIBLE ALARM FROM KEYPAD**

☐ **FIRE ALARM FROM KEYPAD**

☐ **PARTITIONED MODE**

☐ **ABBREVIATED ARMING**

☐ **OPENING AND CLOSING BY USER**

☐ **GROUP BYPASS ZONES** _____

☐ **CHIME ZONES** _____

GENERAL DESCRIPTION

The EKP1L is a digital arming station that provides full system control and displays full system status from one or more convenient locations. A brief description of the functions of each light and the LCD display is shown in Figure 1. Additionally, built into each EKP1L is a miniature sounding device which, when active, indicates various conditions such as a Pre-Alarm Warning, Fault Condition, Test Modes of operation, or Door Annunciation.

Your keypad has the added convenience of additional access codes. These secondary codes are designed to provide access to a maid or other service persons for whom you want to grant entry. Obviously, they can also be used in any other way that you desire.

Arming, disarming, bypassing zones, etc., can be accomplished using any of the codes. In order to change codes from the keypad, use of the primary access code is required. Access codes can be changed from the keypad and must have 4 digits.

IT IS IMPORTANT FOR YOUR SAFETY THAT YOU TEST YOUR SYSTEM REGULARLY.

Figure 1

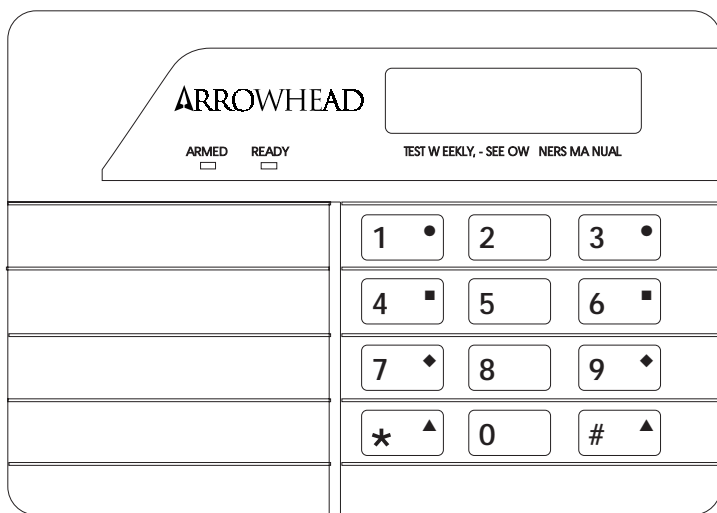

A—Green “**READY Light**” — when on indicates that all protected areas are secure and system is ready to be armed. A blinking ready light indicates a Fault Condition.

B—Red “**General ARMED Light**” — when on indicates system is armed or on. A blinking armed light indicates that an alarm has occurred.

C--The “**LCD DISPLAY**” indicates system status in english, with zone arming, zone bypassing, alarms and trouble conditions all being displayed. System information such as AC FAIL, LOW BATTERY, and FAIL TO COMMUNICATE along with ZONE DESCRIPTIONS will be displayed when needed to clearly show the current condition of the system.

NOTE: This manual will use the default descriptions when referring to the LCD display, and assume Auto Scrolling is enabled. These descriptions may be changed by your installer.

DISARMING AND SILENCING THE SYSTEM (when ARMED light is on)

To Disarm your system (assume Access Code 1234), enter your Access Code, key sequence as follows:

Figure 2

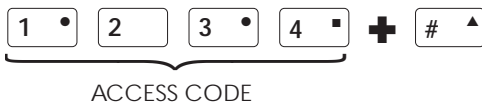

If you disarm your system, the armed light (RED) is off and the LCD display will show READY if all zones are secure, or NOT READY if one or more zones are not secure. If you silence the system after being in ALARM the LCD display will show the zone description of the zone that was in alarm. This is called ALARM MEMORY. It will be cleared the next time the system is ARMED. The 24 Hour zones will remain on all the time and they can be displayed by using Fault Analysis Mode.

RECOMMENDATION: If, when arriving home, the burglar alarm is sounding, contact police from a nearby location. DO NOT ENTER YOUR RESIDENCE.

ARMING SYSTEM WITH READY LIGHT ON OR OFF

If the READY light is on, all zones may be armed by entering your Access Code, using the key sequence in Figure 3. If the READY light is not on you must either go and close the door or window that is open or BYPASS the zone and eliminate it from the system for this ARMING. When the READY light is not on the display will show NOT READY and scroll through the zone descriptions of the zones that are NOT READY.

Figure 3

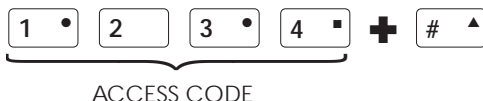

Your system is now armed. The armed light is on and the display shows ARMED

ZONE BYPASS with READY LIGHT ON OR OFF

If the ready light is off the display will show NOT READY and the description of the zone that is open will be scrolling through the display. Let us assume that the zone 3 "FRONT BEDROOM" window is open. The zone 3 description "FRONT BEDROOM" will be in the display. Entering the Access Code will not arm the system because the zone 3 window is open. Suppose that the window is intentionally left open to allow some air circulation and the rest of the zones are to be armed. To bypass a zone, enter your access code, then enter the number of the zone to be bypassed (in this case "3"), enter key sequence as follows:

Figure 4



All the other burglary zones except zone 3 will ARM and the display will show ARMED. Zone 3 is now deactivated. If the window is closed and opened again, an alarm condition will not result, as this zone will be bypassed until the system is disarmed and rearmed. When the system is disarmed the bypass is removed.

Additional zones may be bypassed in the same manner.

GROUP BYPASS

Instead of bypassing zones individually, your installer may have assigned several zones together to be bypassed all at one time. An example would be turning off all the interior zones of the premises allowing movement, while still protecting the perimeter.

Example: Interior zones 2, 3 and 4 have been assigned as GROUP BYPASS zones. To bypass zones 2, 3 and 4 enter the following key sequence:

Figure 5



Zones 2, 3, and 4 will BYPASS but the other zones will ARM. This is a very easy way of arming a part of the system all at one time. The display will show ARMED.

INSTANT/DELAY MODE

The system will normally arm in the Delay Mode when leaving the premise. This will delay arming, allowing time to exit. When entering, the alarm will be delayed allowing time to disarm the system. The audible warning device will sound during the entrance delay reminding you to disarm the system. The Instant Mode is primarily used in residences. It is used during sleeping hours when an entrance delay is not wanted.

If the Instant Mode is desired, enter the key sequence as follows:

Figure 8



The LCD display will show ARMED INSTANT .

PANEL TEST MODE

Your alarm system and its associated components (intrusion detectors, smoke detectors, etc.) should be tested periodically. You can test these devices yourself using the panel test mode. While in test mode the keypad beeps continuously to tell you it is in test

mode but it will not send any alarm signals to the Monitoring Center. As you go through the system tripping the zones you will get a short ring of the bell to let you know when a zone is violated. Entry and exit delays are shortened to 4 secs during the test. After you have tripped all the zones and returned to the keypad you will find all of the zones that responded in ALARM MEMORY. In this way you can quickly test your system using only one person and then verify that all zones worked when you return to the keypad. If the Panel Test Mode is desired enter key sequence as follows:

Figure 9

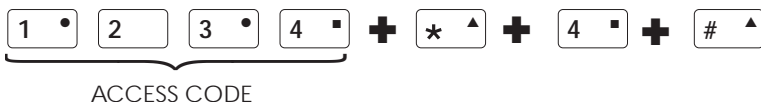

The LCD display will be scrolling through the zones that were tripped. To exit test mode enter your access code.

It is important for your safety that you test your system regularly.

TESTING COMMUNICATOR

Check with your installer as to how to test, and how often to test the communicator portion of your system. Various central monitoring stations have different procedures for testing the communicator. Your installer is familiar with this procedure.

SMOKE DETECTOR RESET

If you have a smoke detector for use with your system, your panel can be programmed to manually reset this device following an alarm condition by **simultaneously pressing** the 1 KEY + 3 KEY on the EKP1L keypad.



ABBREVIATED ARMING

This allows the system to be armed by using only the first one, two, or three digits of the access code. Once your installer has selected the number of digits for abbreviated arming, access code(s) may be changed without effecting abbreviated arming number of digits.

Use full access code for arming if zone bypassing is desired.

OPENING AND CLOSING BY USER

The Opening and Closing by user code identifies the user who disarms (opening) and arms (closing) the system. This is accomplished by assigning an individual access code to each user, (up to 8 users on the AV9000 and SC700). The primary access code is always reported as user one. Seven additional secondary access codes may be selected for the AV9000 and SC700.

Select secondary codes as shown in “Entering or Changing Secondary Access Code” Section.

CHIME MODE

Your installer may have designated certain burglary zones to briefly activate the mini-sounder contained in each keypad. These zones typically annunciate that a door has been opened or closed while the panel was disarmed. To select for chime operation, enter the following key sequence:

Figure 10

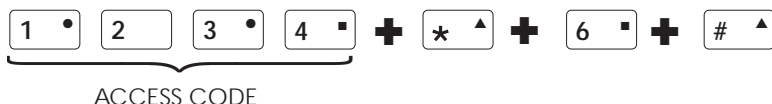

If chime operation is not desired, simply re-enter the key sequence.

FAULT CONDITION

A Fault Condition could, if unheeded, potentially render your system inactive. If such a fault should occur it will be indicated by a flashing green “READY” light, a TROUBLE message on the LCD display, and an audible warning tone at the keypad.

To identify the nature of the Fault Condition, enter the following sequence. This will also silence the audible warning:

Figure 13

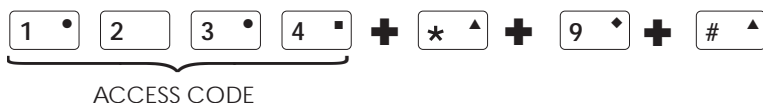

Fault conditions will be displayed on the LCD display.

The LCD display will now indicate the nature of the problem and it will scroll through the problems if there is more than one. Discuss with your installer what action to take if a problem should occur. If a trouble condition occurs on a fire zone, (or Day/Night Trouble

Zone), call your installer for service as an important part of your system is out of order. Other messages that you may see are listed below.

AC OFF: Indicates A.C. power to your alarm system has been disrupted.
LOW BATTERY: Indicates a low battery condition
FAIL COMMUNICATE: Indicates failure to communicate to the central monitoring station.

**IT IS IMPORTANT FOR YOUR SAFETY THAT YOU HAVE YOUR INSTALLER
CORRECT ANY FAULTS AS SOON AS POSSIBLE.**

DURESS (AMBUSH)

Duress is used during a hold-up when you're ordered to disarm your system. When used, a silent alarm is transmitted to the central monitoring station. Press the [9] key (or the [0] key depending on how your system is programmed) after your Access Code, then press the ENTER#. The system will disarm and a silent alarm will be transmitted.

NOTE: This function will only operate during a disarm command.

Normal Disarm Figure 14

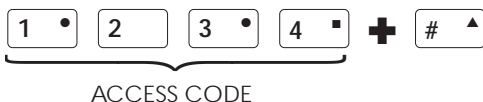

Duress Disarm Figure 15



EMERGENCY ALARM KEY PAIRS

There are four special emergency codes that can be initiated at the keypad. **THESE EMERGENCY ALARM KEY PAIRS MUST BE PRESSED SIMULTANEOUSLY**, (a feature designed to minimize false alarms). For example: Pressing the ENTER# first and then pressing the STAR* key while the ENTER# is still held down will NOT send an emergency signal. The special key pair combinations are marked with a circle, square, diamond, or triangle.

Figure 16

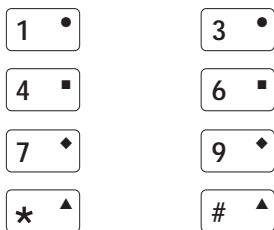

EMERGENCY ALARM KEY PAIRS

Consult your installer/dealer as to which one(s) of these are used, if any, and which combination initiates which alarm. The special symbols above and between the specific rows are to help you identify which keys to press in case of an emergency situation.

Keypad Symbol	Assigned Function	
● Circle	<input type="checkbox"/> Fire Reset	<input type="checkbox"/> _____
■ Square	<input type="checkbox"/> Not Used	<input type="checkbox"/> _____
◆ Diamond	<input type="checkbox"/> Not Used	<input type="checkbox"/> _____
▲ Triangle	<input type="checkbox"/> Not Used	<input type="checkbox"/> _____

PARTITIONED MODE

Your installer/dealer may have assigned specific zone(s) for you. Other users are sharing the same alarm system. There is very little interaction between users, and arming and bypassing zones can be done without interfering with other users. Bypassing zones is explained in the section on conventional mode. Entering the Access Code and then pressing ENTER# will arm or disarm all of your zones. EXAMPLE: Your Access Code is 1234, and you wish to disarm your zones, use the normal arm/disarm key sequence as follows:

Figure 17

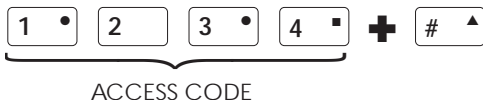

In case of an alarm condition, enter your Access Code plus Enter. This will shut the alarm off.

CHANGING USER CODES

User codes can be changed from the keypad using the following sequence, AAAA [Mode] [CP] {[Mode] n} {CCCC} [Enter], where AAAA is the master code and CCCC is the new code for user number “n”. (See Figure 18 for an example).

NOTE: Only user #1 is allowed to program his or other users' code.

EXAMPLE: Change user number 3's code to 1535.

Figure 18



User numbers 1-8 can be used for the AV9000.

REMOTE DOWNLOADER FUNCTIONS

The panel can be programmed over the phone line using a computer. There are times when you may be instructed by the Monitoring Center to use one of these special commands for that purpose. The panel can be instructed to call the computer or to answer when the computer calls.

These functions should only be used when instructed to do so by personnel at either the Monitoring Center or Installation Company.

CALL THE "ScanPro" DOWNLOADER

To have the panel call the Computer, the following sequence can be entered:

Figure 20



ANSWER THE "ScanPro" DOWNLOADER

When the panel is programmed not to answer the telephone it may be forced to answer the telephone by entering the following sequence:

Figure 21



EVACUATION PLAN

The National Fire Protection Agency recommends the following guidelines to be prepared for an actual fire.

1. Draw a floor plan of the building marking all doors and windows.
2. Evaluate all possible escape routes from building, trying each route.
3. Select two (2) escape routes from each room.
4. Second floor rooms should have a rope ladder that reaches the ground.
5. Draw a sketch of the escape route and familiarize everyone in the home with it.
6. Select a meeting place outside where everyone is to report.
7. Practice the escape plan with everyone in household.
8. Advise the local fire department that a fire alarm system is installed.
9. Figure 22 shows an example of an evacuation plan.

**FOR MORE INFORMATION WRITE: NFPA
1 Battery March Park
Quincy, MA 02269**

APPROVAL OF FIRE AUTHORITY DOES NOT INCLUDE BURGLAR INSTALLATION OR EQUIPMENT. FOR TECHNICAL ASSISTANCE PLEASE CONTACT YOUR INSTALLER/DEALER.

Figure 22

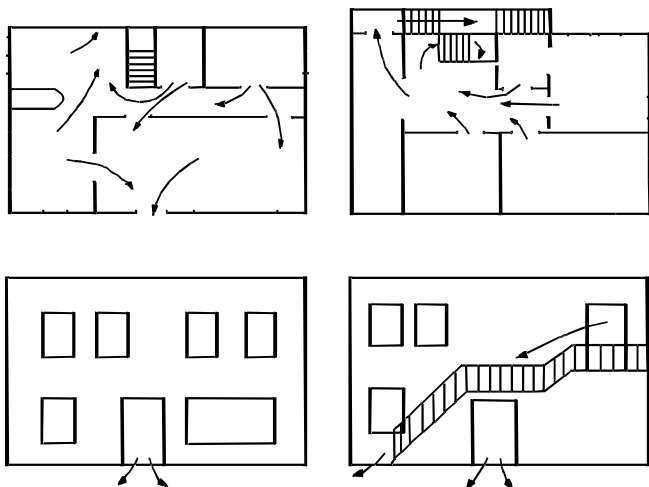

WARRANTY AND LIABILITY LIMITATIONS AND DISCLAIMER

LIMITED WARRANTY

Sentrol, Inc., warrants to the purchaser that under normal use and service, its products will be free from defects in material and workmanship as follows: Control Panels and accessories - 24 months from date of manufacture; Sensors and accessories - 60 months from date of manufacture. Sentrol, Inc.'s warranty obligation is limited to repairing or replacing (at Sentrol, Inc.'s sole option) equipment which has been, during the warranty period and not more than thirty 30 days after discovery, reported to Sentrol, Inc., as defective in material or workmanship and is so found to be by Sentrol, Inc., upon inspection. For the purposes of this Warranty, Purchaser refers to wholesale purchaser, installer and retail purchaser. Retail purchaser must, however, in the case of defect, contact the person or entity who installed and maintains the product who in turn should contact Sentrol, Inc., in accordance with the terms of this Limited Warranty.

Examination and repair or replacement of such equipment will be performed at Sentrol, Inc.'s facilities located in Hickory, North Carolina with no charge to purchaser for service time expended, except as otherwise stated in this Warranty Limitations and Disclaimer. Equipment to be examined, replaced or repaired at Sentrol, Inc.'s facilities must be returned to Sentrol, Inc., by purchaser within the warranty period, insurance and transportation charges prepaid. Prior to the return of the equipment, wholesale purchasers or installers shall obtain a return authorization number from Sentrol, Inc.'s Customer Service Department. Retail purchasers are to contact the person or entity who installed and maintains the product. Under no circumstance Sentrol, Inc., will be responsible for expenses or labor incurred in removing and reinstalling its products from the retail purchaser's location. If examined equipment is found not to be defective or is not for some other reason within the warranty coverage, Sentrol, Inc.'s service time expended will be charged to purchaser.

Purchaser shall be responsible for all maintenance, service, replacing expendable parts, making minor adjustments and performing operating checks, all in accordance with procedures outlined in Sentrol Inc.'s operation manual. This Warranty shall not apply to any product failure that results from purchaser's failure to properly maintain, service, adjust, inspect and test the product in accordance with Sentrol, Inc.'s operation manual.

WARRANTY LIMITATION AND EXCLUSION

The repair or replacement of any product under this Warranty Limitation and Disclaimer shall in no event extend the term of the warranty beyond the original term set forth herein.

Sentrol, Inc., will have no further warranty obligation under this agreement if the equipment is subject to tampering, abuse, misuse, electronic disruption, negligence, accident, flood, fire, acts of God, improper installation, application or programming, improper maintenance or repair, alteration, repair or installation by an unauthorized installer or repair facility, improper storage, transportation or handling, or if purchaser fails to perform any of the procedures set forth in the manual, and/or instruction sheet; specifically, the equipment must have been installed in accordance with the instructions and operated in accordance with the instructions. In particular, the unit must be programmed for regular test and the tests must be conducted on a regular basis, but no less often than once per week.

This Warranty does not apply to components or parts manufactured by any person or entity other than Sentrol, Inc. Any repair or replacement of product within this Warranty must be performed by Sentrol, Inc.

DISCLAIMER OF WARRANTIES

THE WARRANTY PRINTED ABOVE IS THE ONLY WARRANTY APPLICABLE TO THIS PURCHASE. ALL OTHER WARRANTIES, EXPRESS OR IMPLIED, INCLUD

ING, BUT NOT LIMITED TO, THE IMPLIED WARRANTY OF MERCHANTABILITY AND FITNESS FOR A PARTICULAR PURPOSE ARE DISCLAIMED.

NO OTHER PERSON OR ENTITY HAS BEEN AUTHORIZED BY SENTROL, INC. TO MODIFY OR CHANGE THE TERMS OF THIS WARRANTY. ANY AFFIRMATION OF FACT OR PROMISE MADE TO THE PURCHASER WHICH RELATES TO THE GOODS SOLD UNDER THIS AGREEMENT SHALL NOT BE REGARDED AS A PART OF THE BASIS OF THE BARGAIN AND SHALL NOT BE DEEMED TO CREATE AN EXPRESS WARRANTY THAT THE GOODS SHALL CONFORM TO THE AFFIRMATION OR PROMISE. ANY DESCRIPTION OF THE GOODS SOLD UNDER THIS AGREEMENT SHALL NOT BE REGARDED AS A PART OF THE BASIS OF THE BARGAIN AND SHALL NOT BE DEEMED TO CREATE AN EXPRESS WARRANTY THAT SUCH GOODS SHALL CONFORM TO THE DESCRIPTION.

SENTROL, INC. DOES NOT WARRANT THAT THE PRODUCT WILL MEET OR COMPLY WITH THE REQUIREMENTS OF ANY SAFETY CODE REGULATION, STATUTE OR ORDINANCE OF ANY STATE, MUNICIPALITY OR OTHER JURISDICTION.

LIMITATION OF LIABILITY

SENTROL, INC. DOES NOT, BY WAY OF THIS LIMITED WARRANTY OR IN ANY OTHER MANNER, WARRANT OR GUARANTEE THAT THIS PRODUCT WILL PREVENT PERSONAL INJURY OR PROPERTY LOSS. PURCHASER SHOULD TAKE ALL REASONABLE AND AVAILABLE PRECAUTIONS IN PROTECTING HIS OR HER SAFETY. IT IS UNDERSTOOD AND AGREED THAT SENTROL, INC.'S LIABILITY WHETHER IN CONTRACT, IN TORT, UNDER ANY WARRANTY, IN NEGLIGENCE OR OTHERWISE, SHALL NOT EXCEED THE RETURN OF THE AMOUNT OF THE PURCHASE PRICE PAID BY PURCHASER AND UNDER NO CIRCUMSTANCES SHALL SENTROL, INC. BE LIABLE FOR SPECIAL, INDIRECT OR CONSEQUENTIAL DAMAGES. THE PRICE STATED FOR THE EQUIPMENT IS A CONSIDERATION IN LIMITING SENTROL, INC.'S LIABILITY. NO ACTION, REGARDLESS OF FORM, ARISING UNDER THIS WARRANTY MAY BE BROUGHT BY PURCHASER MORE THAN ONE (1) YEAR AFTER THE CAUSE OF ACTION HAS ACCRUED.

This Limited Warranty gives you specific legal rights and you may also have other rights which vary from state to state. Some states do not allow limitation on how long an implied warranty will last or the limitation or exclusion of incidental or consequential damages, so the above limitations or exclusion may not apply to you, if not allowed by law.

Should purchaser have any questions with regards to this Warranty and Liability Limitations and Disclaimer they should contact:

Sentrol, Inc.
1510 Tate Boulevard
Hickory, North Carolina 28601
(800) 800-2626